

Cardington Square, Hounslow, TW4 6AJ

£575,000

An extended three/four bedroom semi-detached family home situated in this ever popular residential location with easy access to Hounslow West tube station, shopping centre and bus routes. The accommodation comprises, on the ground floor, through lounge, extended dining room which is currently used as bedroom four, extended kitchen and cloakroom, on the first floor three bedrooms and a family bathroom with separate w/c. Outside front and rear gardens and a detached garage. An internal viewing is strongly recommended. Call now for more details.

A partner of
The Guild Of Professional Estate Agents
with a network of over 700 independent estate agents

Associated Office: 121 Park Lane, Mayfair, London W1K 7AG t 020 7318 7075

Entrance Hallway

Side aspect double glazed window, radiator, understairs cupboard.

Cloakroom

Low level w/c, wash hand basin.

Through Lounge



Front aspect double glazed window, radiator, laminate flooring, power point, double opening doors to...



Extended Dining Room (Bedroom Four)

Radiator, double glazed door to garden.

Kitchen



Single drainer stainless steel sink unit with mixer tap and cupboard below, further range of wall and floor mounted units, space for cooker, side aspect double glazed window, part tiled walls, tiled flooring.



First Floor Landing

Side aspect double glazed window, access to loft space, doors to rooms.

Bedroom One



Front aspect double glazed window, built-in wardrobe, radiator.

Bedroom Two



Rear aspect double glazed window, radiator, built-in wardrobes.



Extended Dining Room



Wall mounted units, space for washing machine and fridge/freezer, part tiled walls, tiled flooring, wall mounted boiler, double glazed door to garden.

Bedroom Three

Rear aspect double glazed window, radiator.

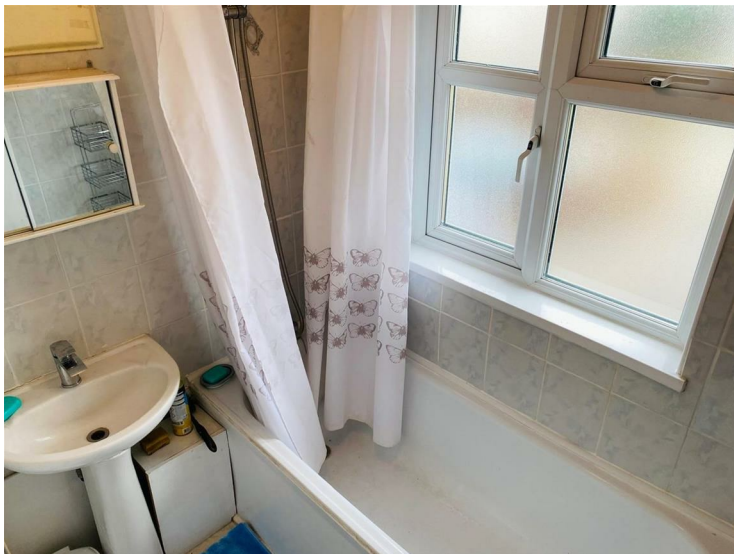
Bathroom

White suite comprising panel enclosed bath, pedestal wash hand basin, tiled walls.

Separate W/C

Low level w/c, tiled walls, double glazed window.

Outside**Rear Garden**

Paved patio area, rest laid to lawn area with shrub borders and fruit trees.

Front

Enclosed block paved area.

Detached Garage

Access via shared driveway.

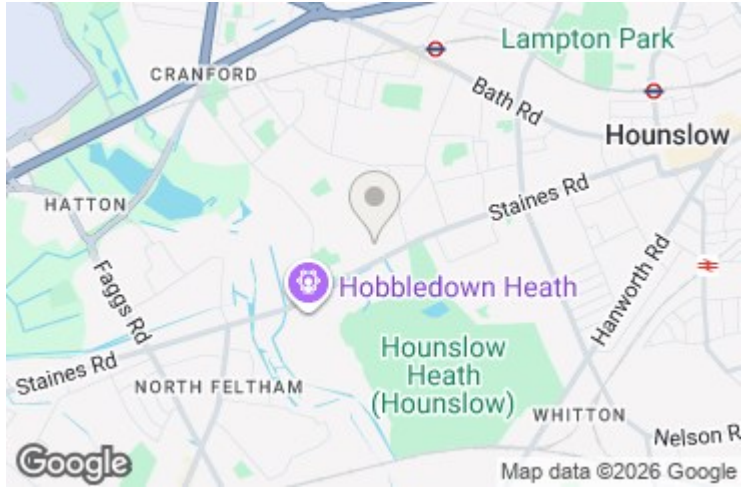

Cardington Square, Hounslow, TW4 6AJ

Approximate Gross Internal Area
96.00 sq m / 1033 sq ft

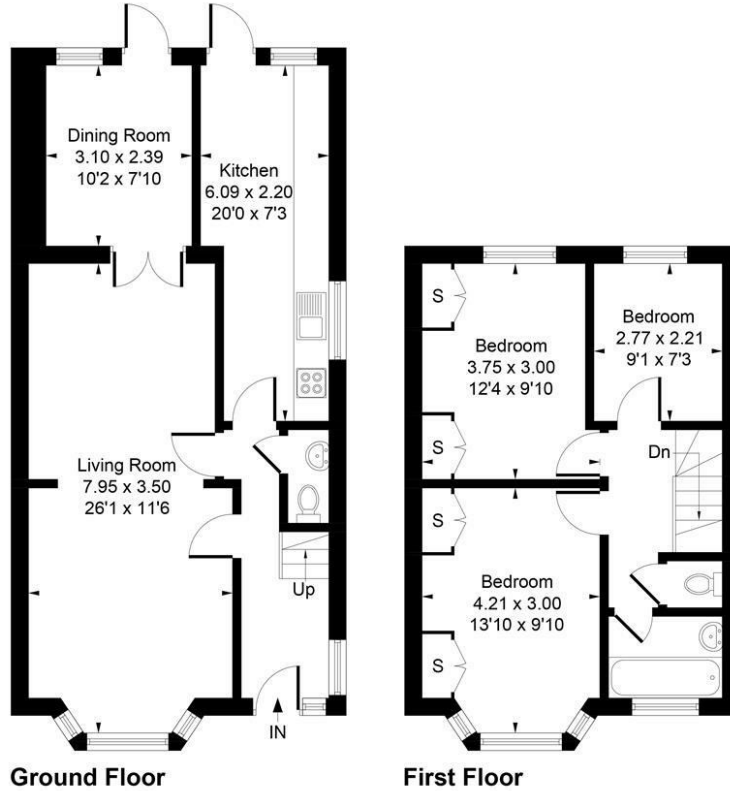

Whilst every attempt has been made to ensure the accuracy of the floor plan contained here, measurements of doors, windows, rooms and any other items are approximate and no responsibility is taken for any error, omission, or mis-statement. This plan is for illustrative purposes only and should be used as such by any prospective purchaser.
Produced by jcphotographystudio.com



Energy Efficiency Rating		Current	Potential
Very energy efficient - lower running costs			
(92 plus) A			
(81-91) B			
(69-80) C			
(55-68) D			
(39-54) E			
(21-38) F			
(1-20) G			
Not energy efficient - higher running costs			
England & Wales		EU Directive 2002/91/EC	
Environmental Impact (CO ₂) Rating		Current	Potential
Very environmentally friendly - lower CO ₂ emissions			
(92 plus) A			
(81-91) B			
(69-80) C			
(55-68) D			
(39-54) E			
(21-38) F			
(1-20) G			
Not environmentally friendly - higher CO ₂ emissions			
England & Wales		EU Directive 2002/91/EC	

A partner of
The Guild Of Professional Estate Agents
with a network of over 700 independent estate agents

Associated Office: 121 Park Lane, Mayfair, London W1K 7AG t 020 7318 7075